

## Issue 26

In this issue, you will assemble the upper rear shock absorber and attach it to the floor panel. Next, fix the rear shock absorber brackets to both the left and right sides of the lower rear axle housing, then combine it with the upper rear axle housing.



# Assemble the Rear Axle (3)

※In this guide "Left" or "(L)", and "Right" or "(R)", refer to the direction as viewed from the driver's seat.

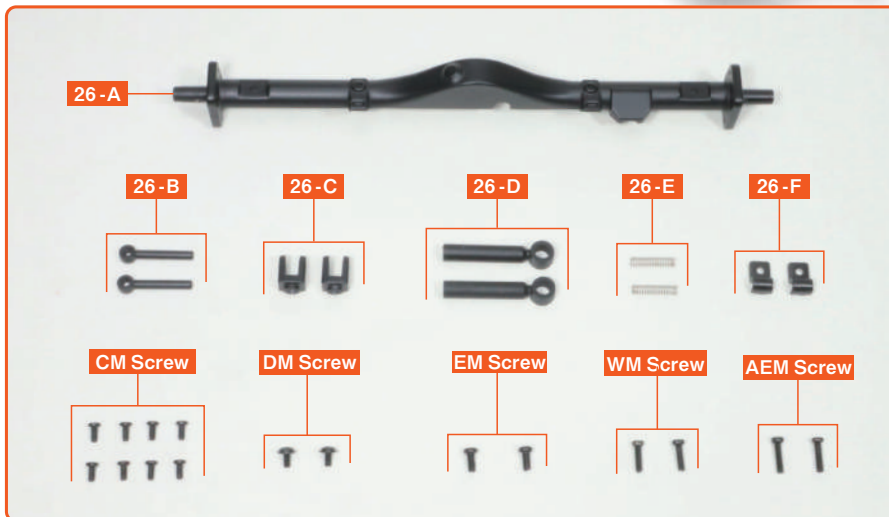

**26-A** Lower Rear Axle Housing

**26-B** Upper Rear Shock Absorber×2

**26-C** Upper Rear Shock Absorber Bracket×2

**26-D** Lower Rear Shock Absorber×2

**26-E** Rear Shock Absorber Spring×2

**26-F** Rear Stabilizer Bar Bolt×2

**CM Screw** (2.0×4 mm) ×8+Spare

**DM Screw** (2.0×4×5 mm) ×2+Spare

**EM Screw** (2.0×5 mm) ×2+Spare

**WM Screw** (2.0×7 mm) ×2+Spare

**AEM Screw** (2.0×8 mm) ×2+Spare

Apology and Correction We apologise for an error in the name of a part provided in Issue 24. Please refer to the correction below.

**Incorrect 24-A** Lower Rear Axle Housing **Correct 24-A** Upper Rear Axle Housing

View the follow-along video



※Due to the model's design, the shapes of some parts may differ from those of the real vehicle.

## step 1 Assemble the upper rear shock absorber

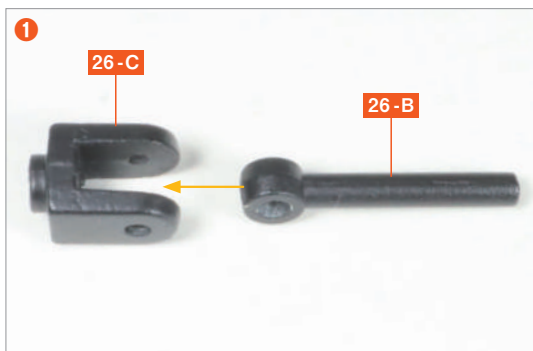

Insert the upper rear shock absorber **26-B** between the U-shaped section of the upper rear shock absorber bracket **26-C**, aligning the screw holes.

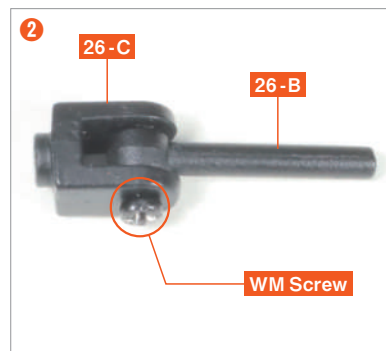

Secure with the **WM screw**. If tightening is difficult, use a cloth for better grip or pre-thread the hole with the **WM screw** before attaching part **26-B**.



In the same way as Step **1** **2**, insert part **26-B** into the other **26-C** and secure it with a **WM screw**.

4 Please note that the shape of the screw holes on the rear floor panel **21-A** has been changed from the photographs shown in Issues 21 and 22. This does not affect assembly.

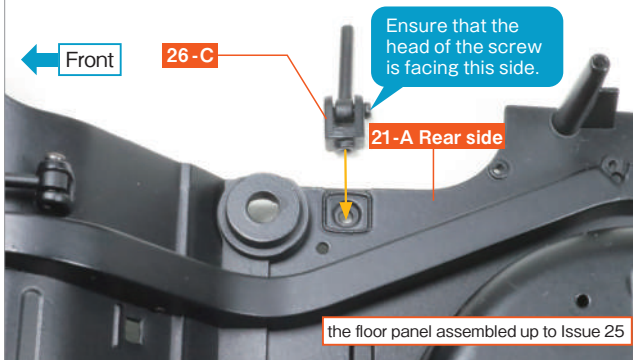

Prepare the floor panel assembled up to Issue 25, then fit the protrusion on the screw hole of part **26-C** into the recess on the reverse side of **21-A**.

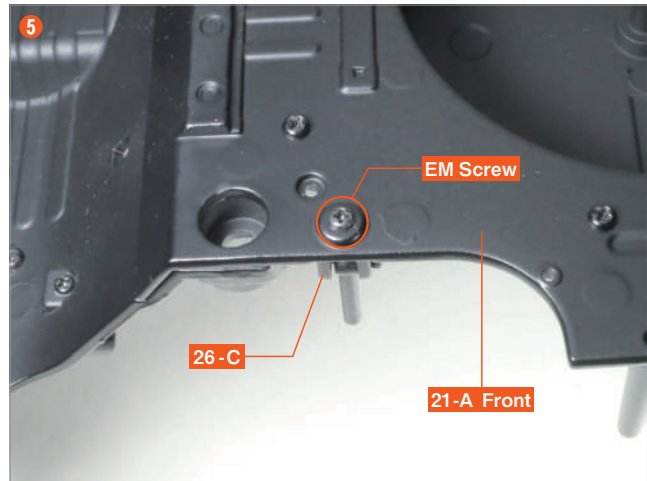

Hold part **26-C** in place to prevent it from coming loose, then turn the floor panel over to the front side and secure it with an **EM screw**. If the screw is difficult to tighten, wrap part **26-C** in a cloth or towel to improve your grip while tightening.

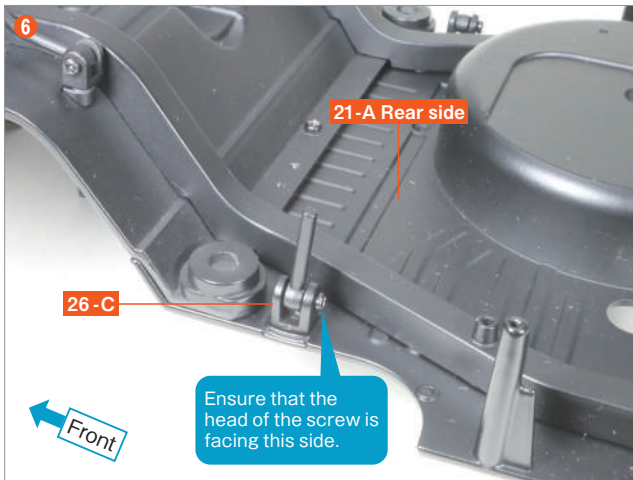

Repeat the same process on the opposite side, fitting the protrusion on the screw hole of part **26-C** into the recess on the reverse side of **21-A**.

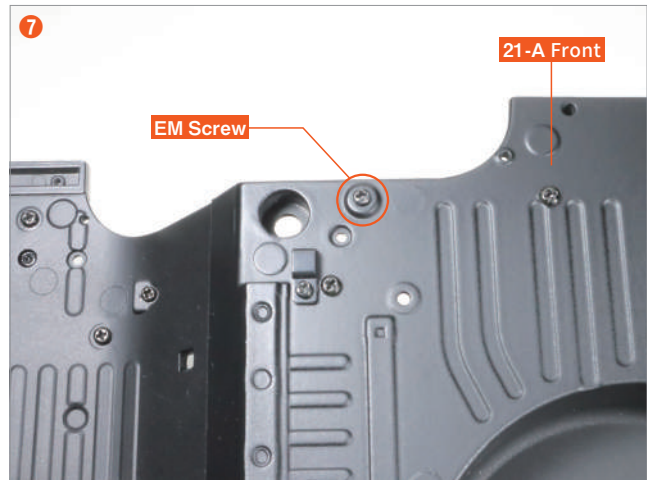

As in Step **6**, hold part **26-C** in place to prevent it from coming loose, then turn the floor panel over to the front side and secure it with an **EM screw**.

**Step complete**

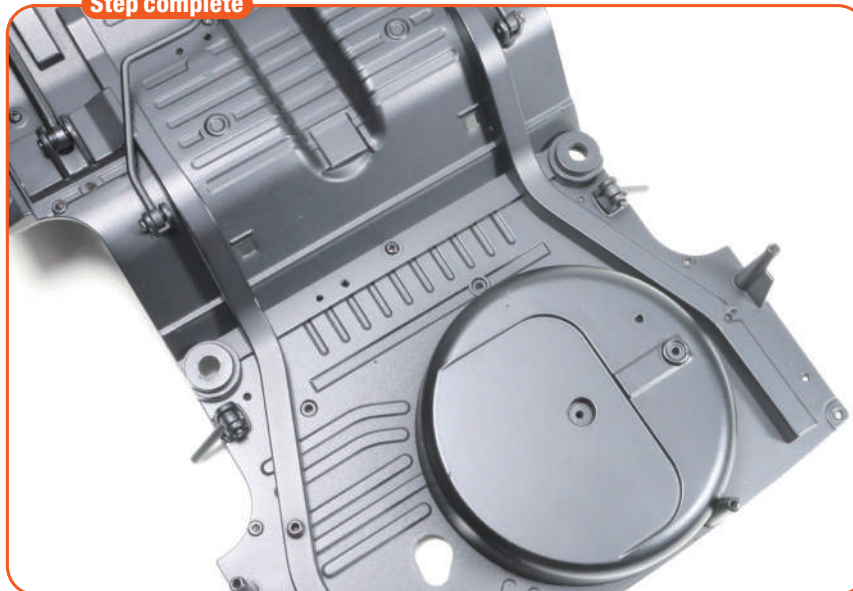

## step 2 Assemble the lower rear shock absorber bracket

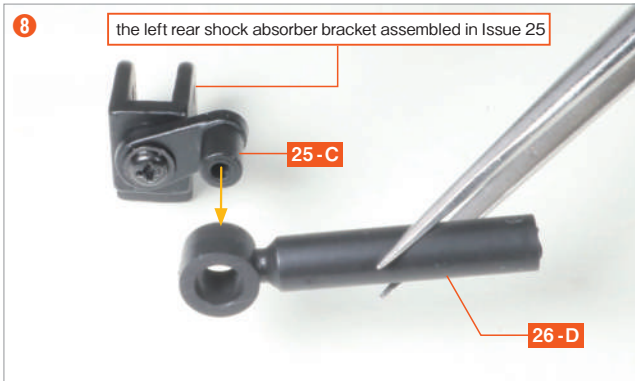

Take the left rear shock absorber bracket assembled in Issue 25, and insert the protrusion of rear shock absorber bracket L (2) **25-C** into the hole in the lower rear shock absorber **26-D**.



Take the right rear shock absorber bracket assembled in Issue 25. Insert the protrusion of rear shock absorber bracket R (2) **(25-E)** into the hole in the other **26-D**, and secure it with a **DM screw**. Take care not to overtighten the screw, allowing part **26-D** to move freely.



## step 3 Assemble the lower rear axle housing

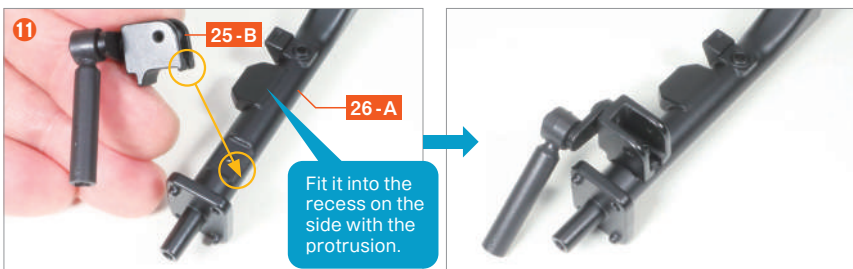

Take the left rear shock absorber bracket assembled in Step 9, align the protrusion of rear shock absorber bracket L (1) **25-B** with the recess on the lower rear axle housing **26-A**, and fit it into place, aligning the screw holes.

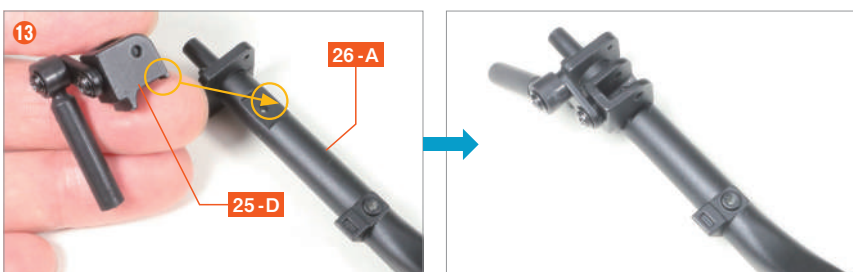

Take the right rear shock absorber bracket assembled in Step 10, align the protrusion of rear shock absorber bracket R (1) **25-D** with the recess on part **26-A**, and fit it into place, aligning the screw holes.



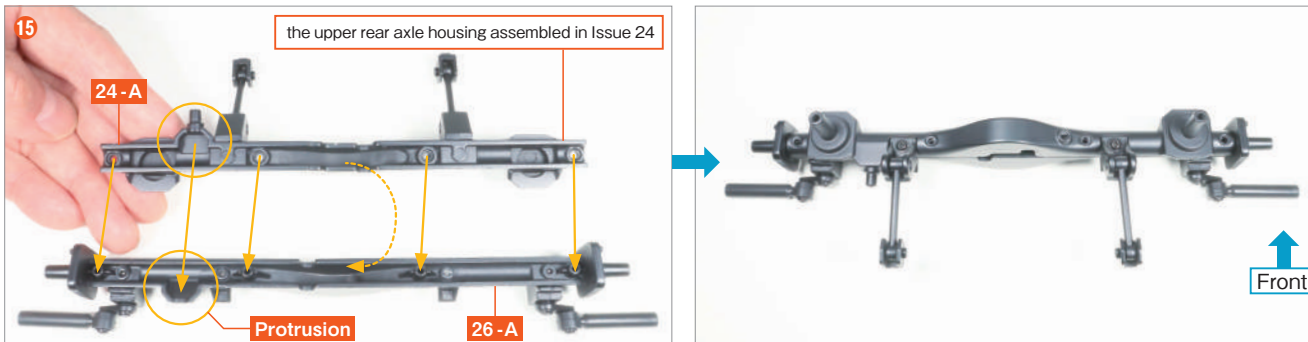
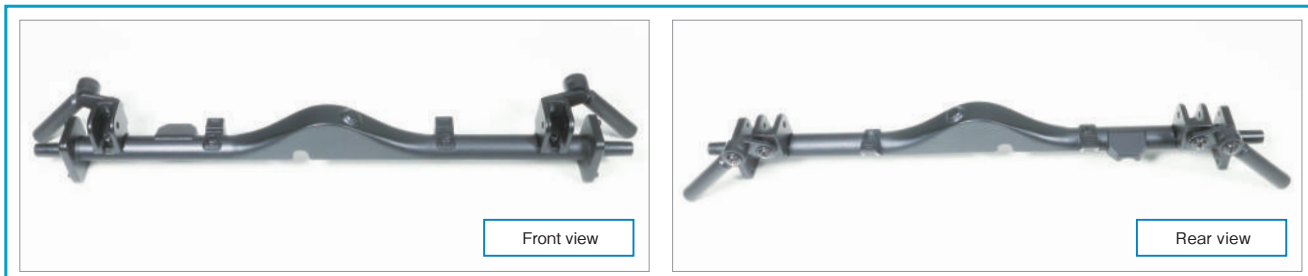

Take the upper rear axle housing assembled in Issue 24, align the protrusion on part **24-A** with the four screw holes on part **26-A**, and fit them together.



Secure the four points with **CM screws**.



## Complete

The assembly for Issue 26 is complete. The two shock absorber springs (26-E), two rear stabiliser bar stoppers (26-F), two CM screws and two AEM screws will be used in a later issue, so please keep them in a safe place until then. In Issue 27, you will complete the rear axle and attach it to the floor panel.

